

Jeep CJ-7

Project

# Index

Donor CJ-5

Tear Down

Fender Rust

Tub Rust

Frame Rust

Engine

Axles

Buildup

Tub

Drawings

Engine

Transmission & Transfer Case

Frame

Drawings

Axles

Rolling Chassis

Original Donor

Jeep CJ-5



Jeep

SPORT KING A/T STEEL RADIAL

IF SIGN



TEXAS  
F15 GVT  
THE GREAT STATE



STEEL RABBIT  
SPORT KING

TEXAS  
F15 GVT  
REGISTERED IN TEXAS





F15 GYT

SPORT KING A/T

J  
S







WARRANTY  
SALES  
SERVICES  
FINANCING

1-800-854-8548  
www.chevrolet.com

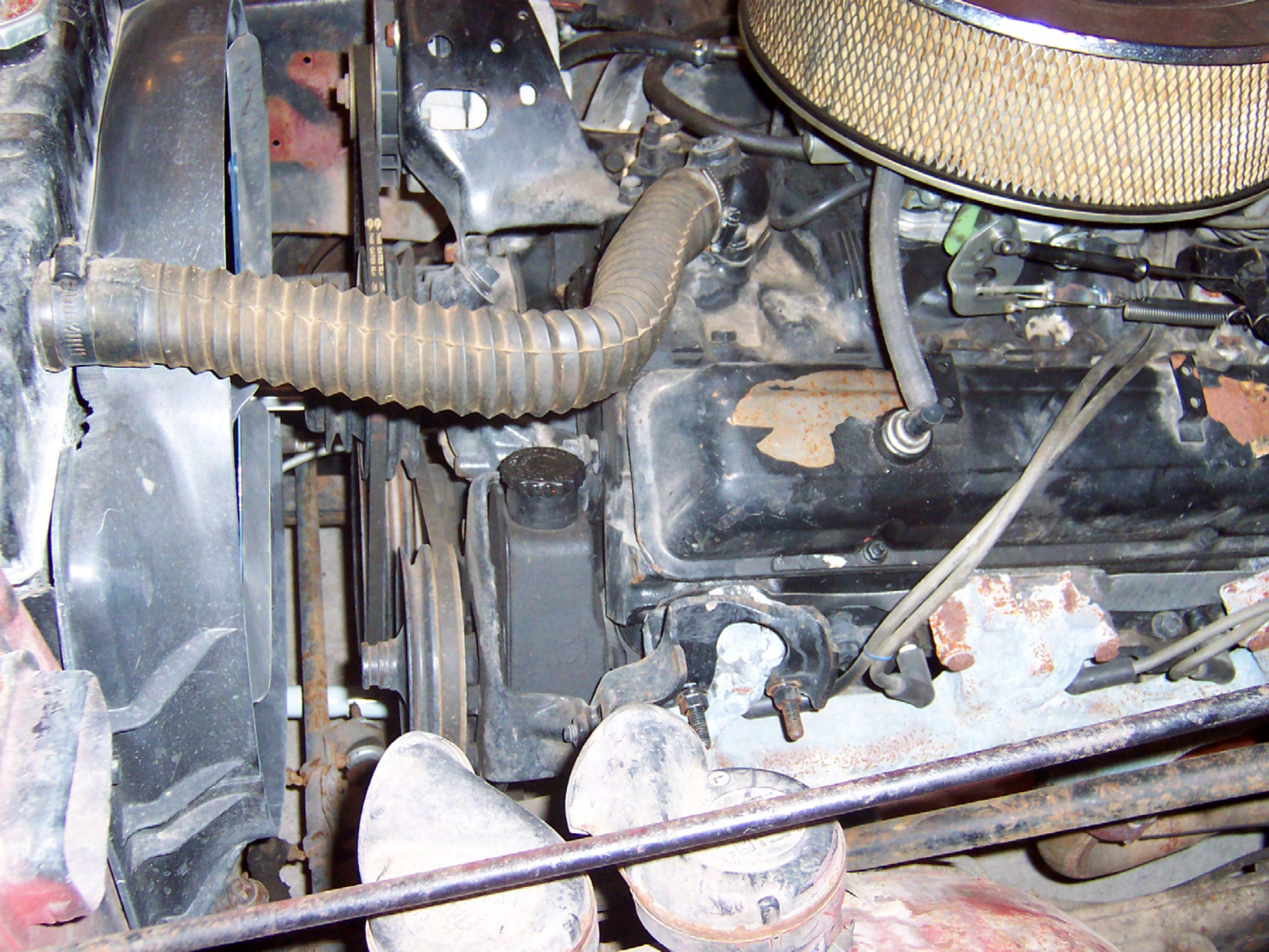

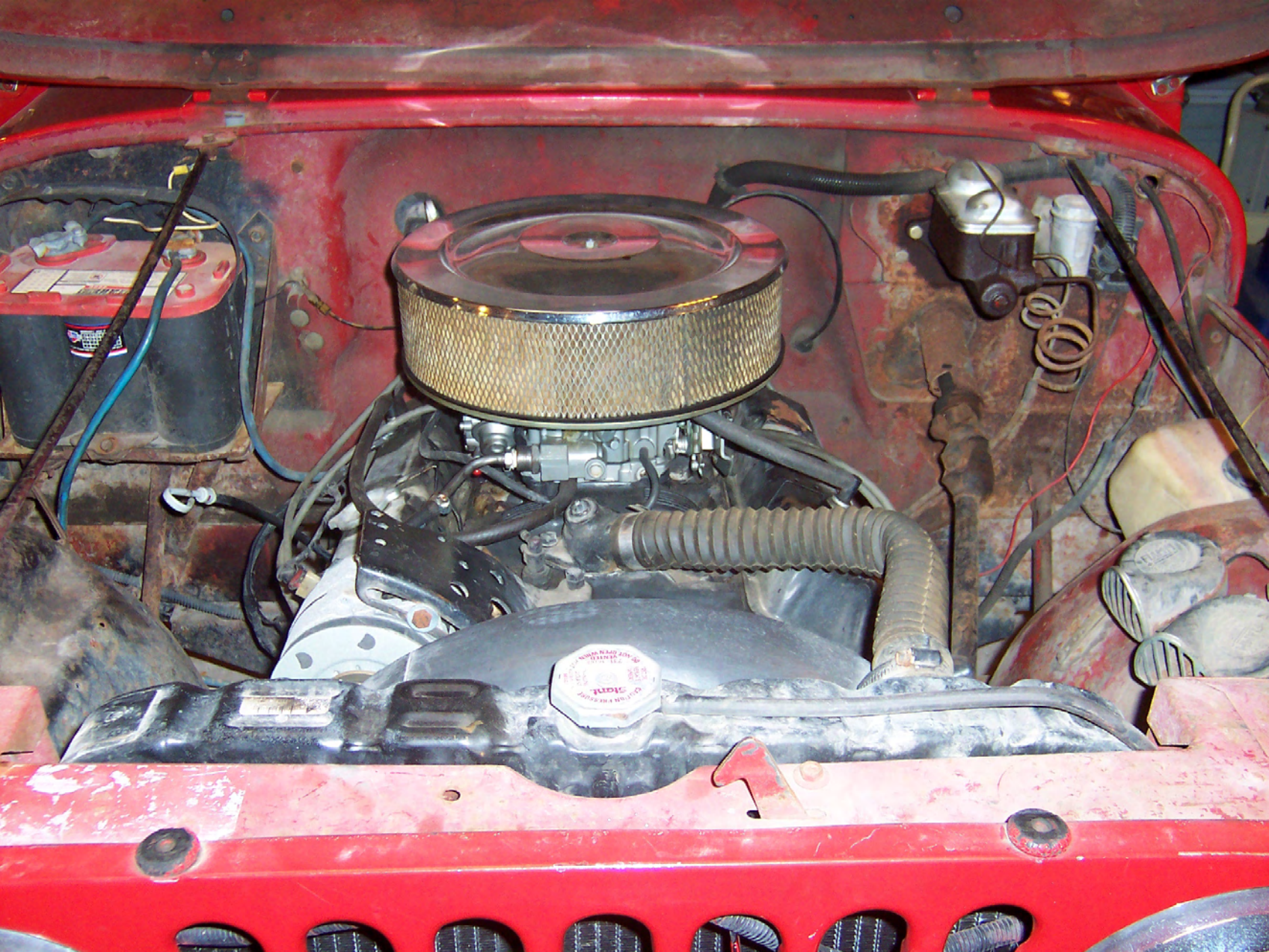

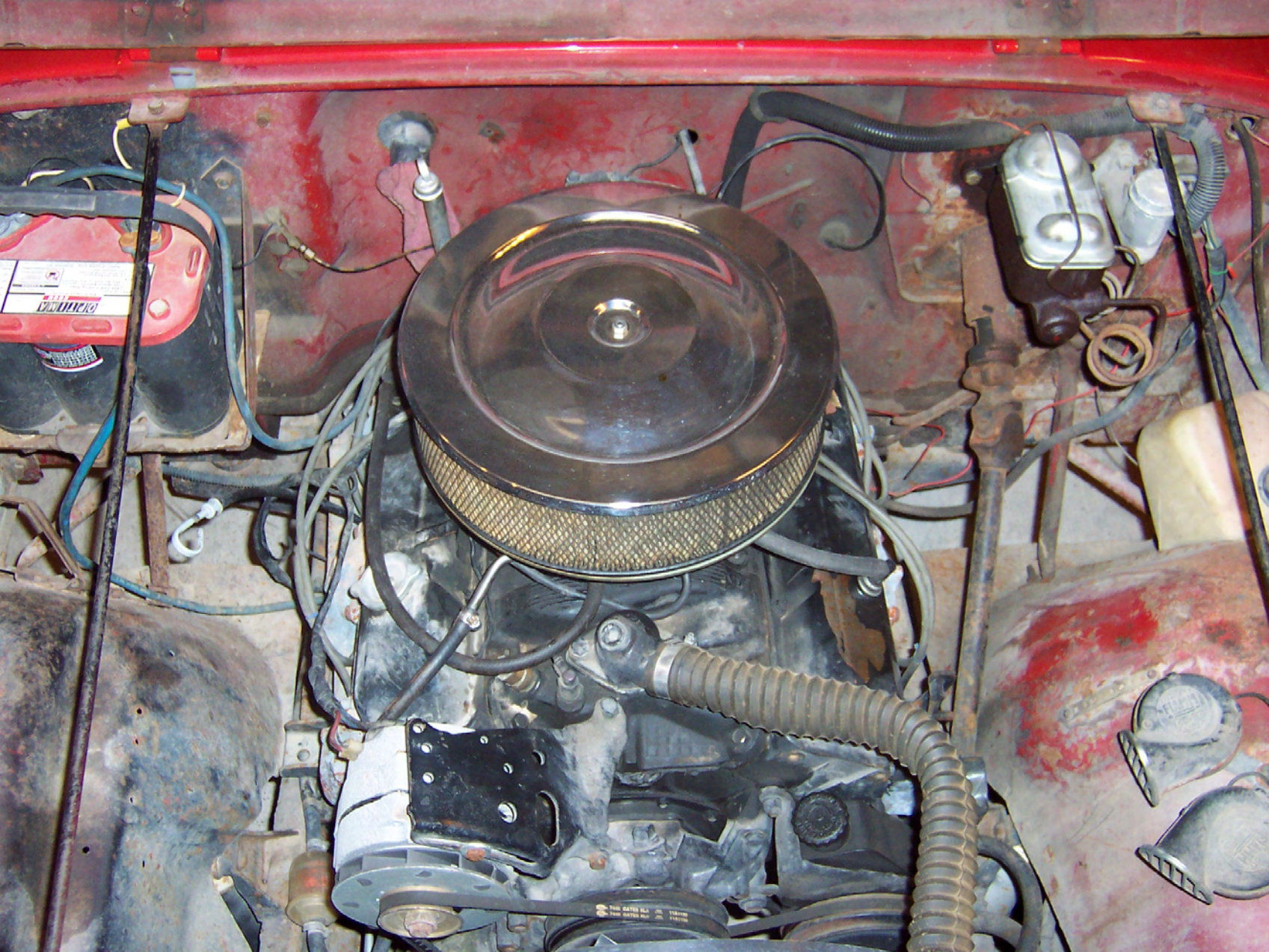



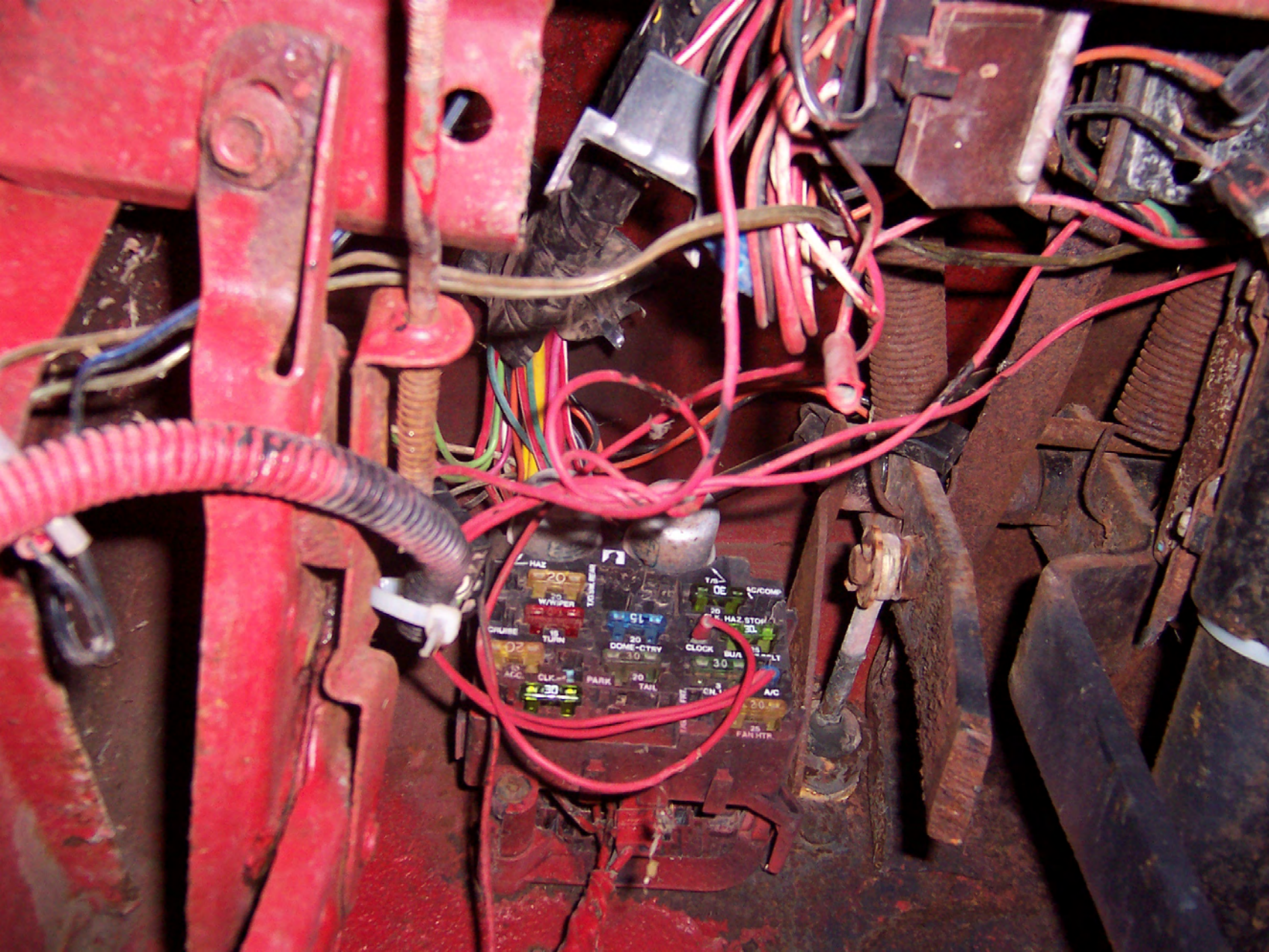

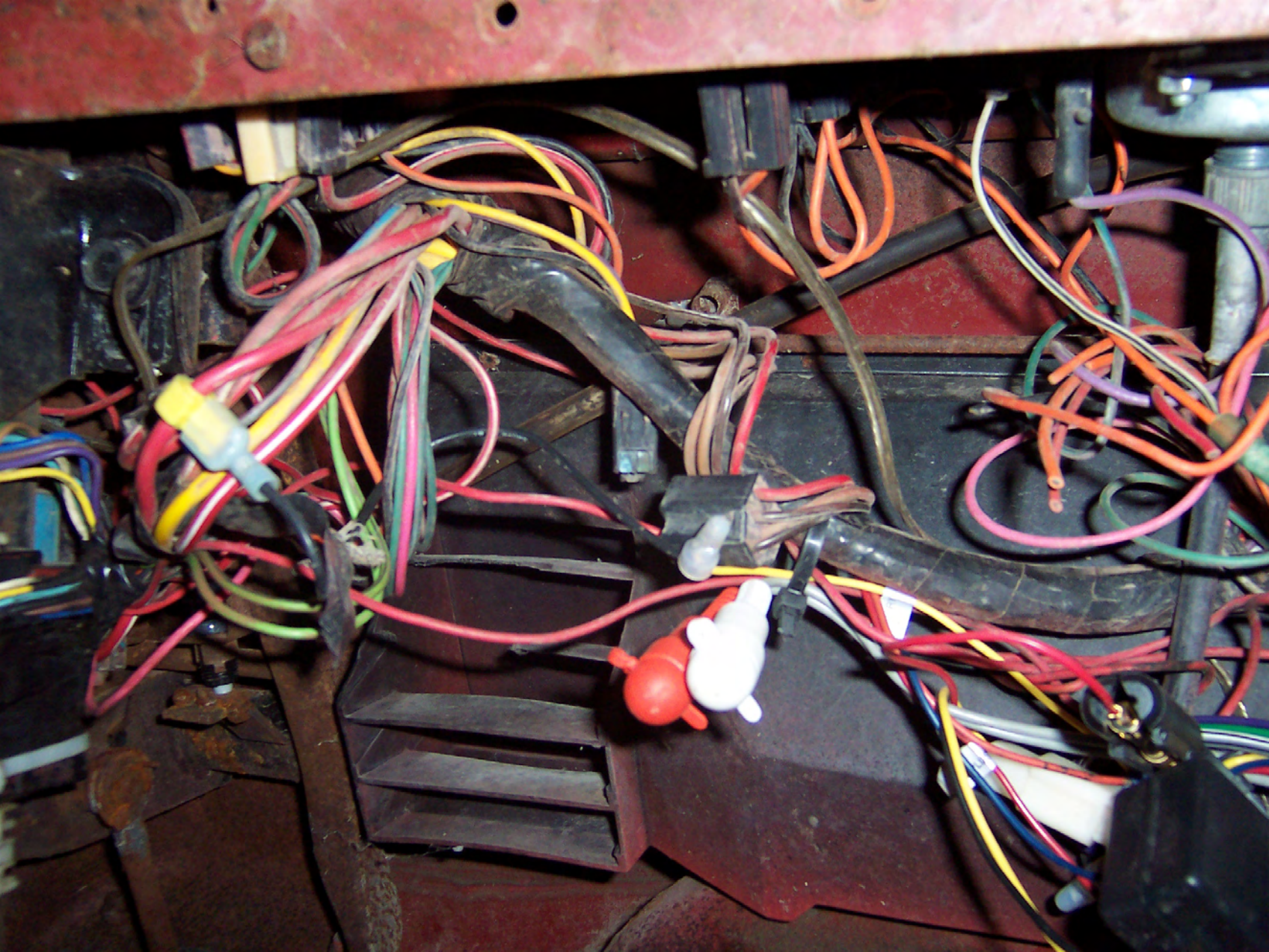



**Teardown**









# Original Chassis











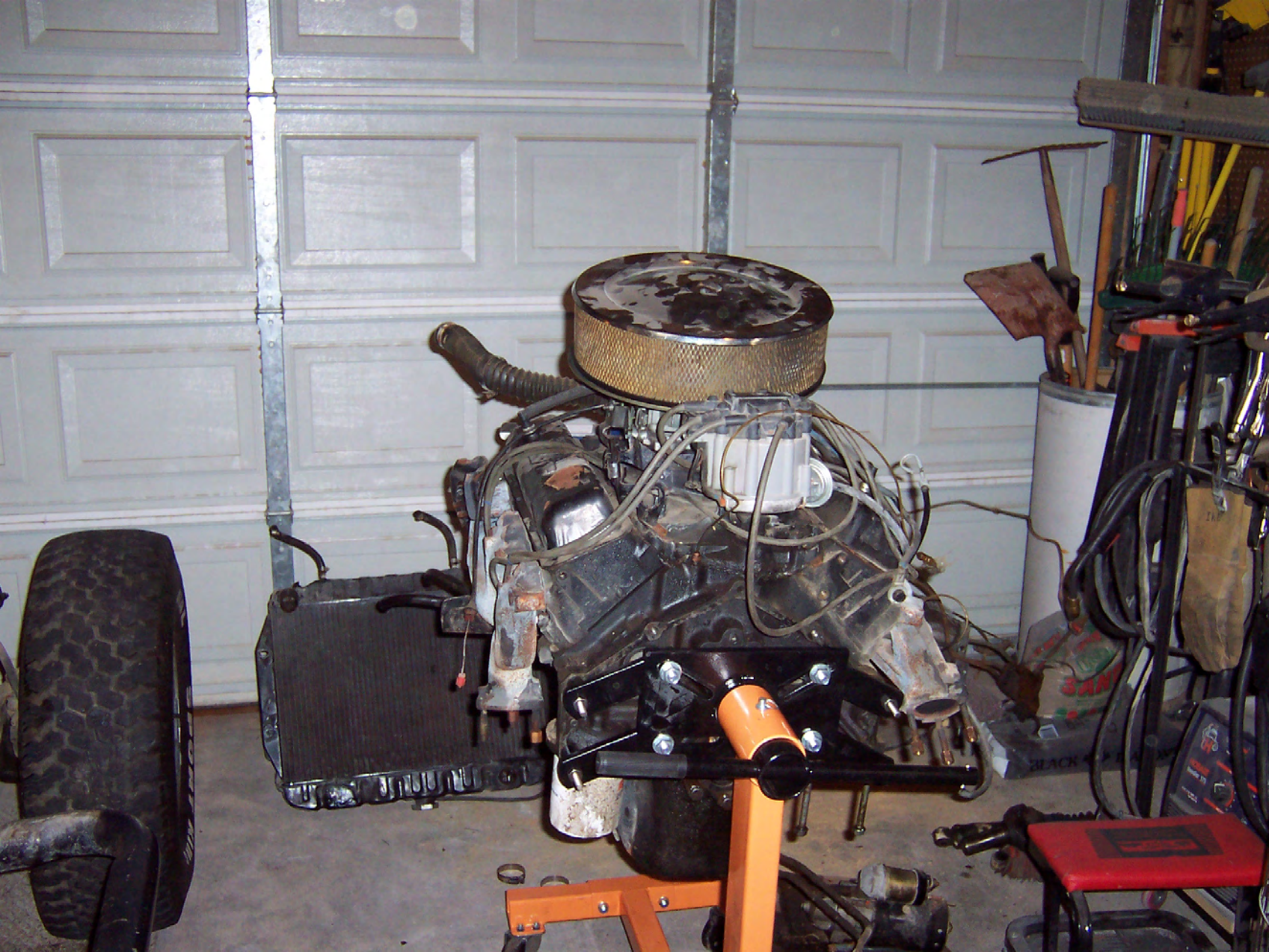









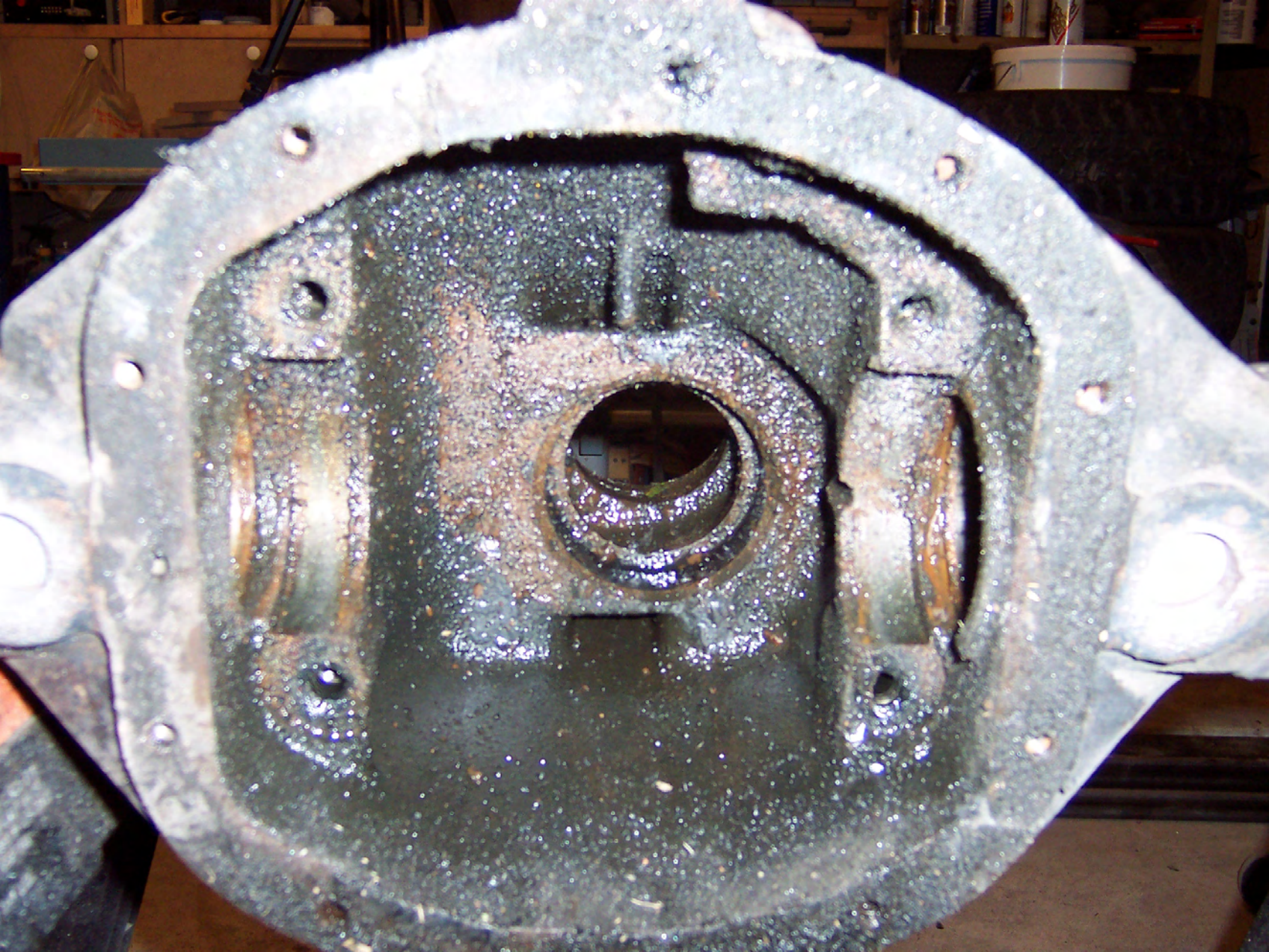



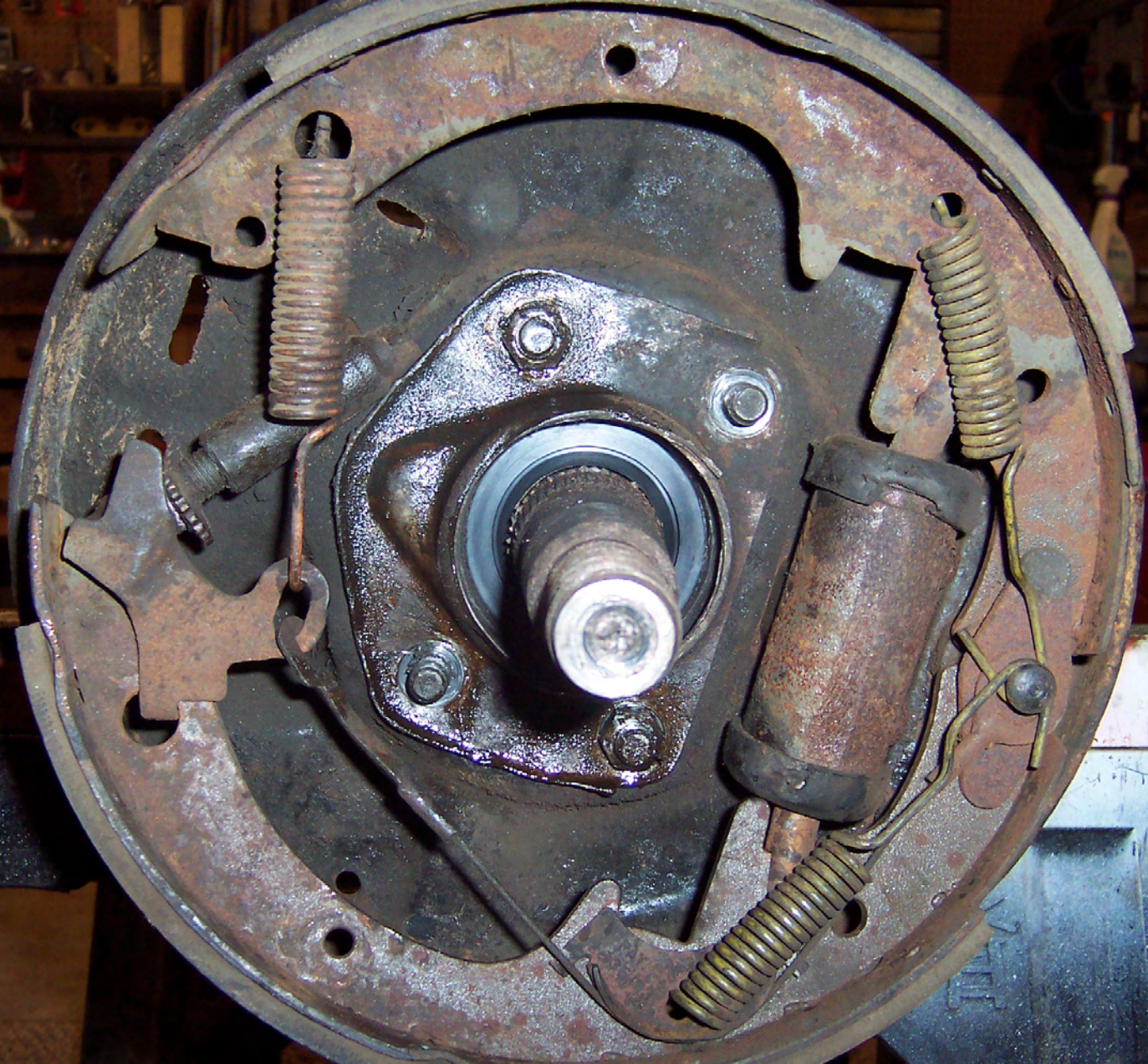

**Buildup**

# Axle Rebuild

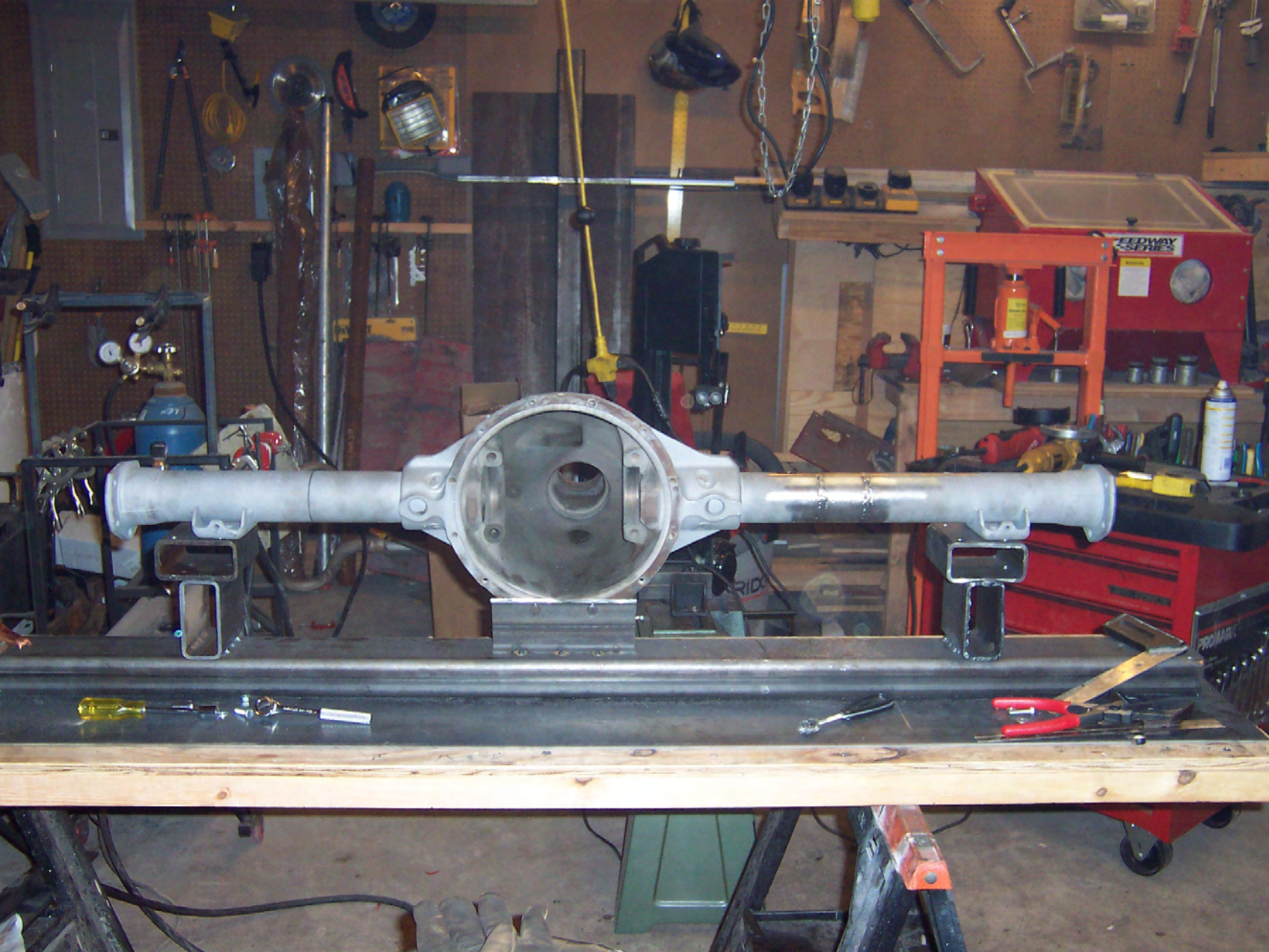

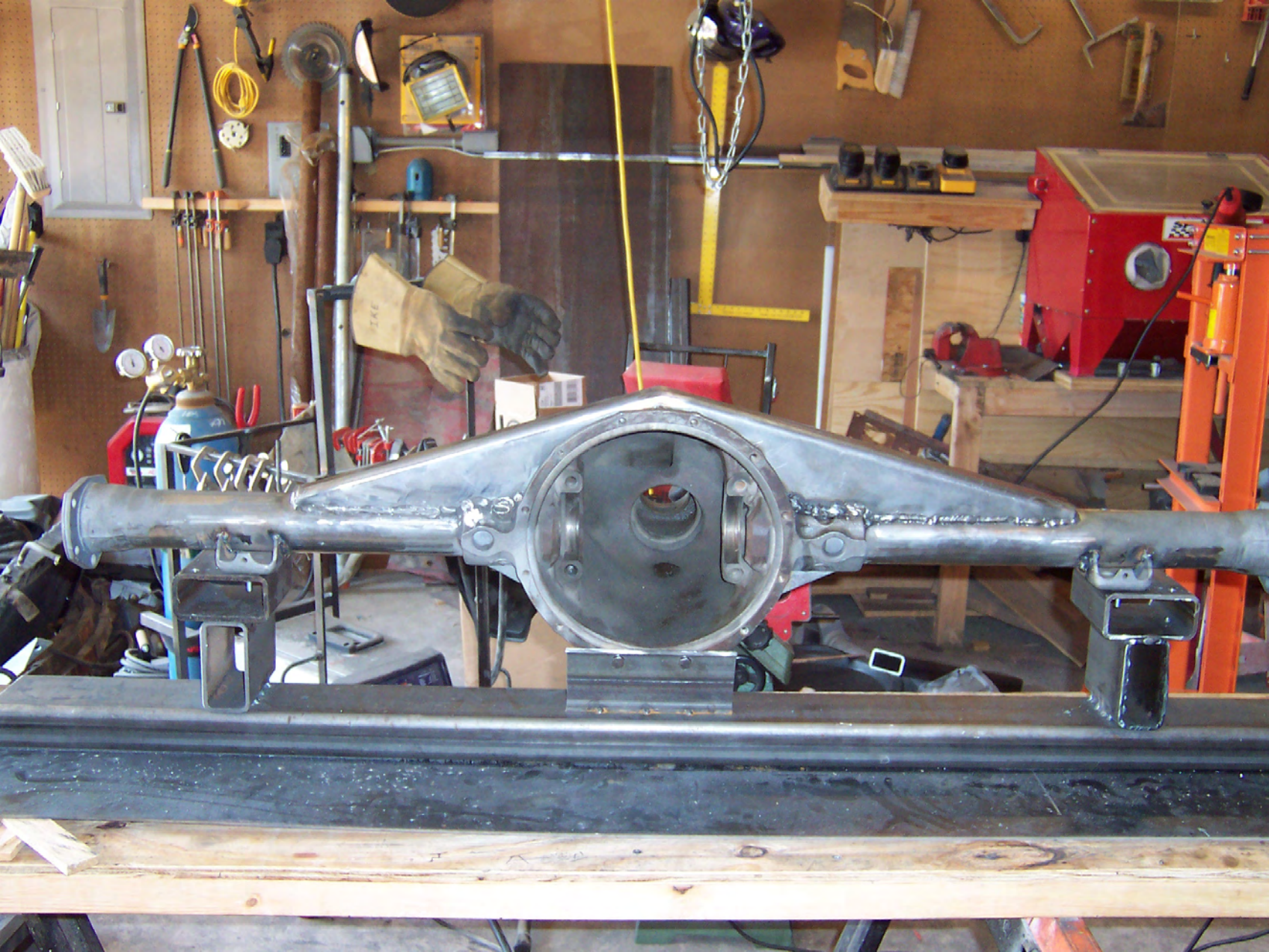

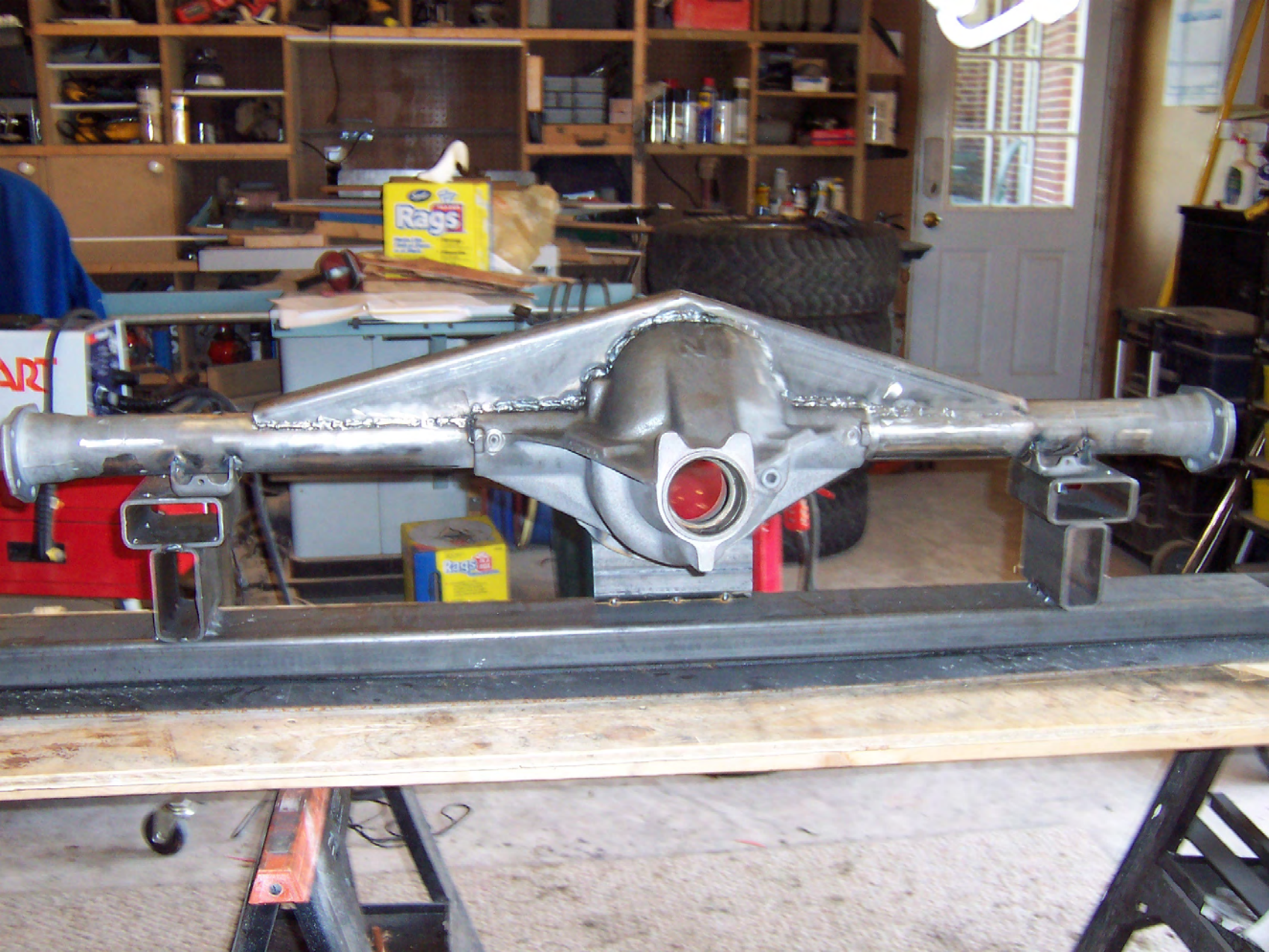

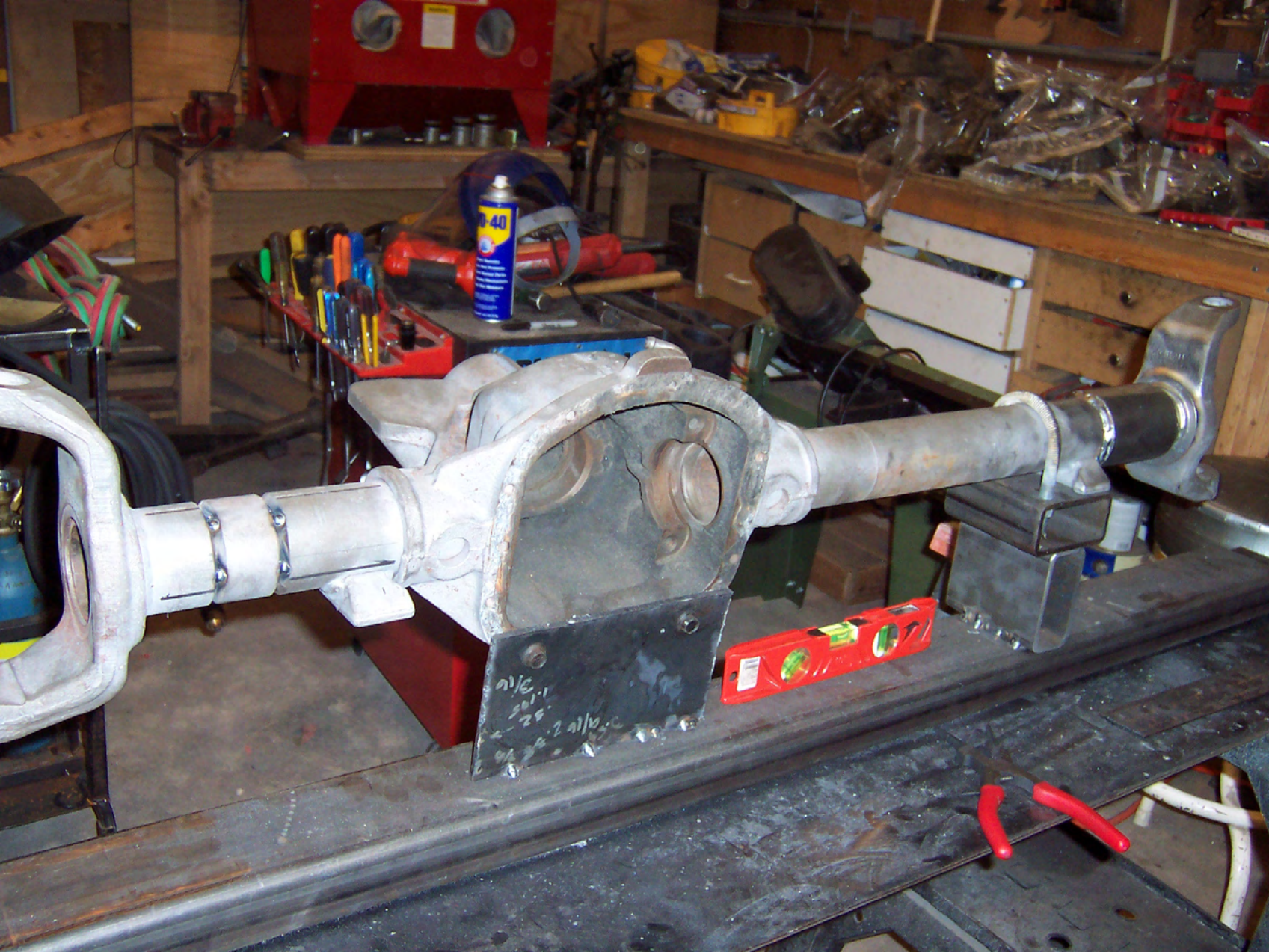

2 1/2  
2 1/2  
2 1/2

# New Tub Construction









FIRST  
AID







SPEEDWAY  
SERIES

1507







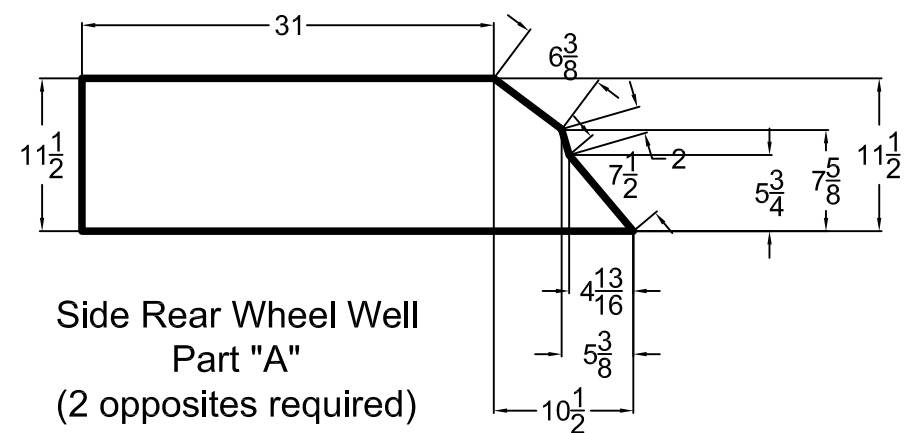

Side Rear Wheel Well  
Part "A"  
(2 opposites required)

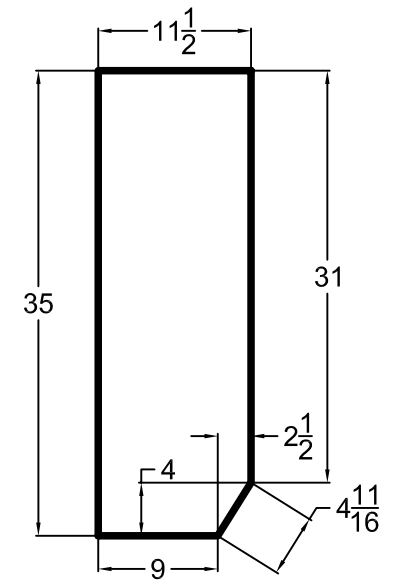
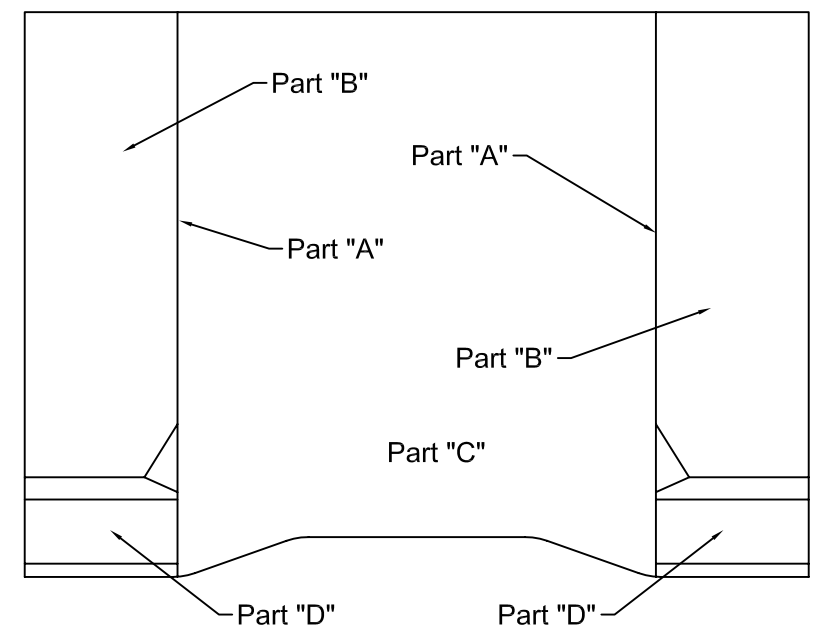

Top Rear Wheel Well  
Part "B"  
(2 opposites required)

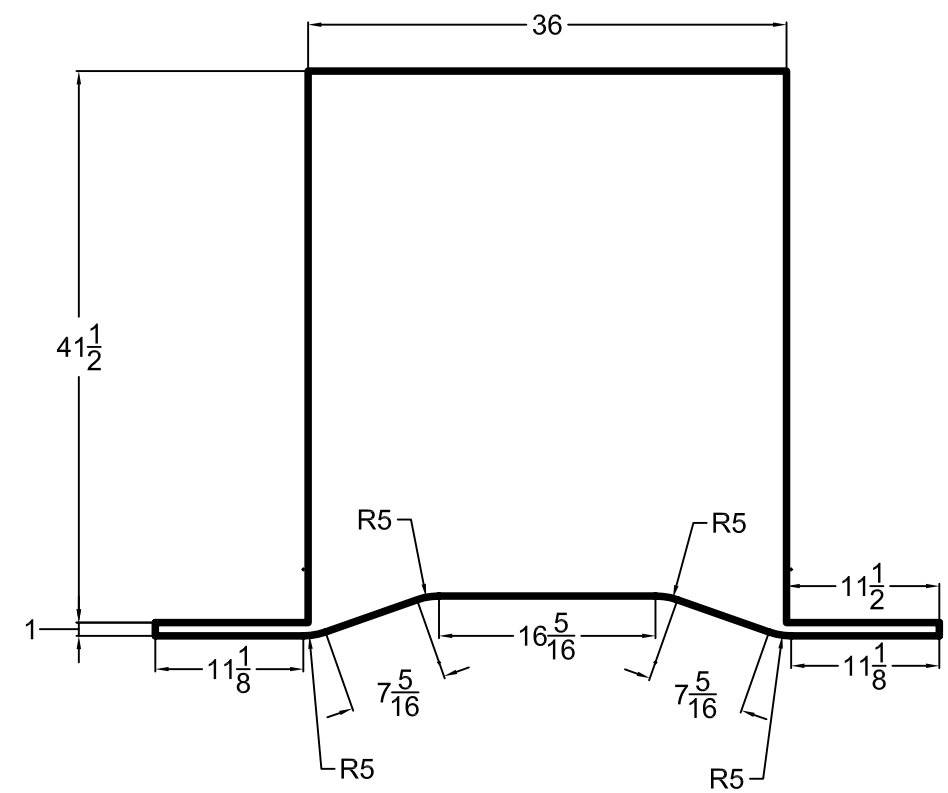

Rear Floor Bed  
Part "C"  
(1 required)

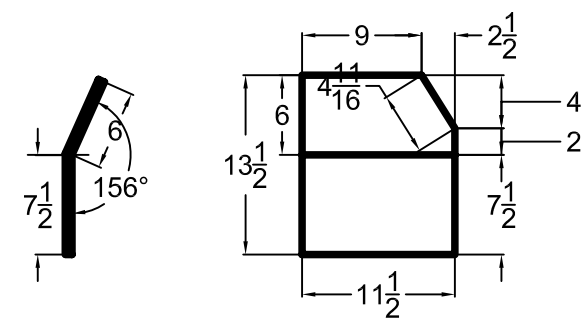

Front Rear Wheel Well  
Part "D"  
(2 opposites required)

ISS	DATE	MODIFICATIONS	DRAWN	CHK'D
				SCALE :
				NONE
Jeep CJ-7 Bed Layout				
Page 1 of 1				
Dwg. no. _____			Project no. _____	

# New Frame Construction



HOBART







# JEEP CJ-7

## Side View Common both Rails

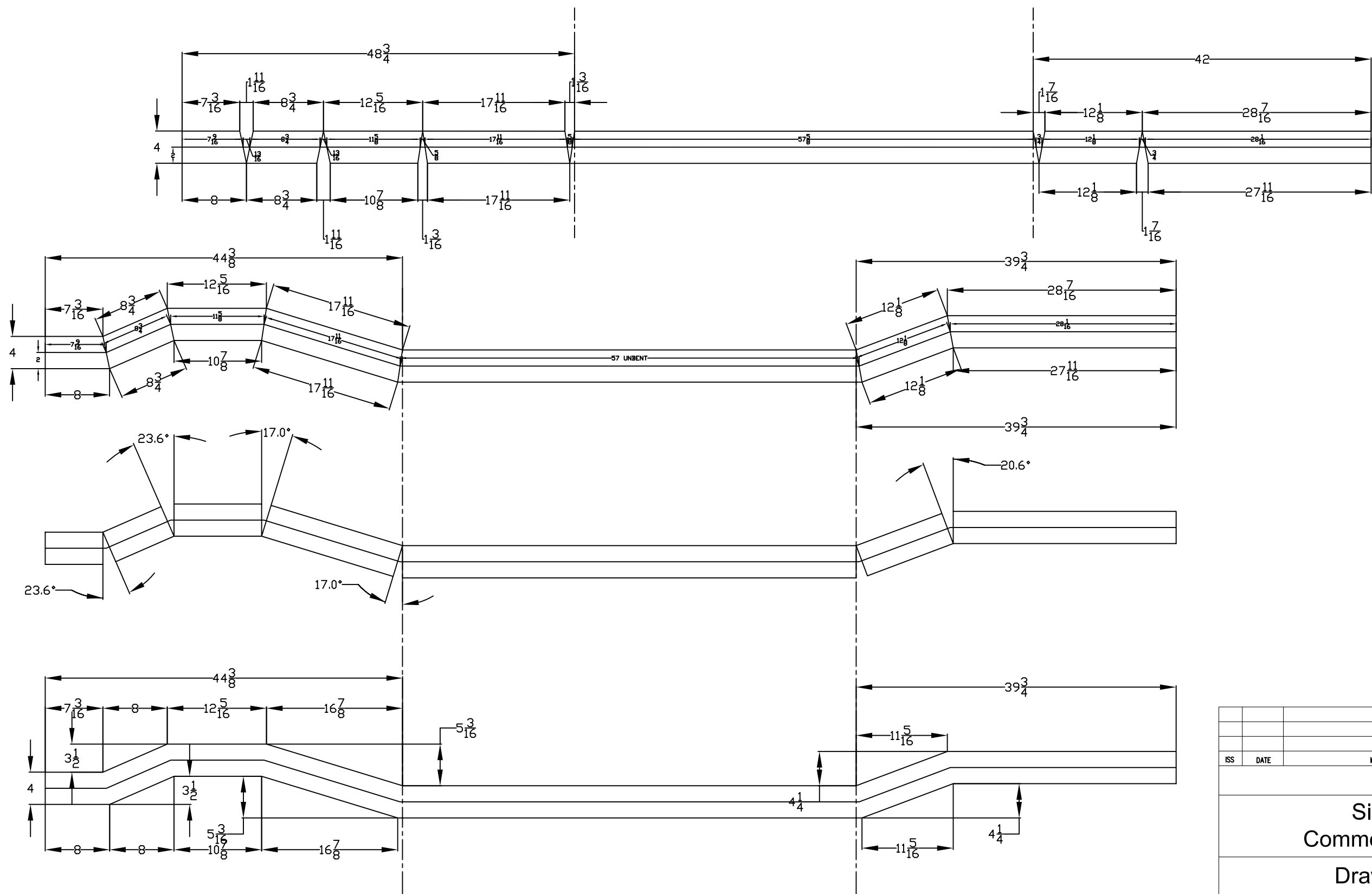

ISS	DATE	MODIFICATIONS	DRAWN	CHK'D
SCALE :			NONE	
<h3>Side View Common both Rails</h3> <h3>Drawing 1 of 6</h3>				
Dwg. no. _____			Project no. _____	

# Jeep CJ-7 Driver Side Rail

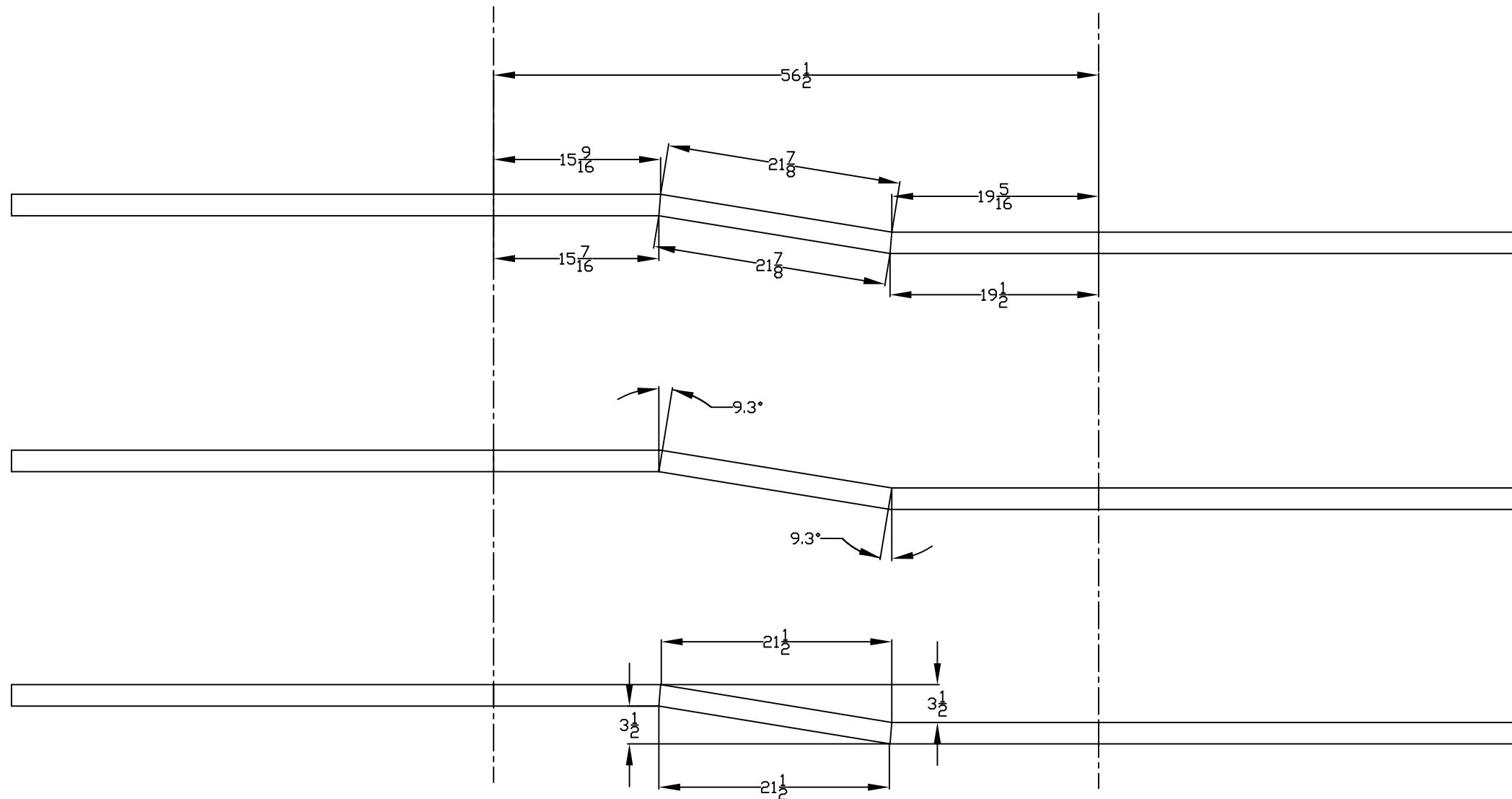
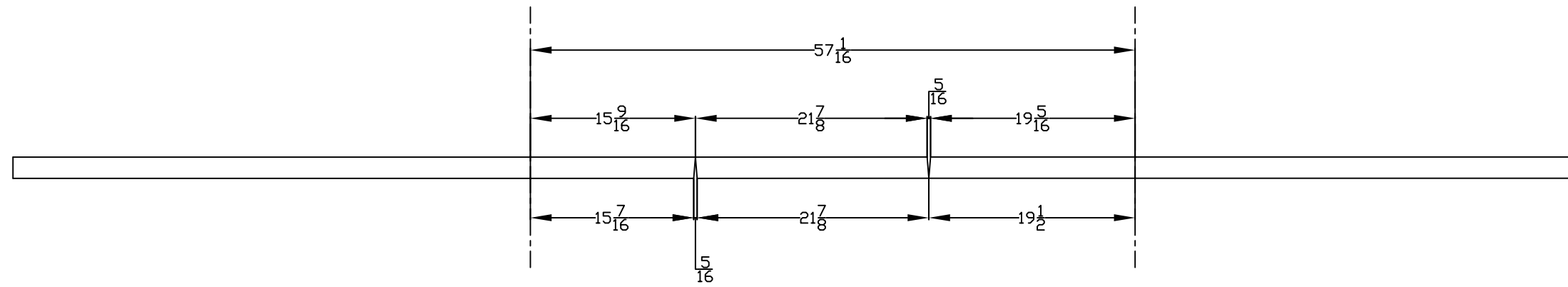

ISS	DATE	MODIFICATIONS	DRAWN	CHKD
				SCALE : NONE
Jeep CJ-7 Driver Side Rail				
Drawing 2 of 6				
Dwg. no. _____			Project no. _____	



# Jeep CJ-7 Passenger Side Rail

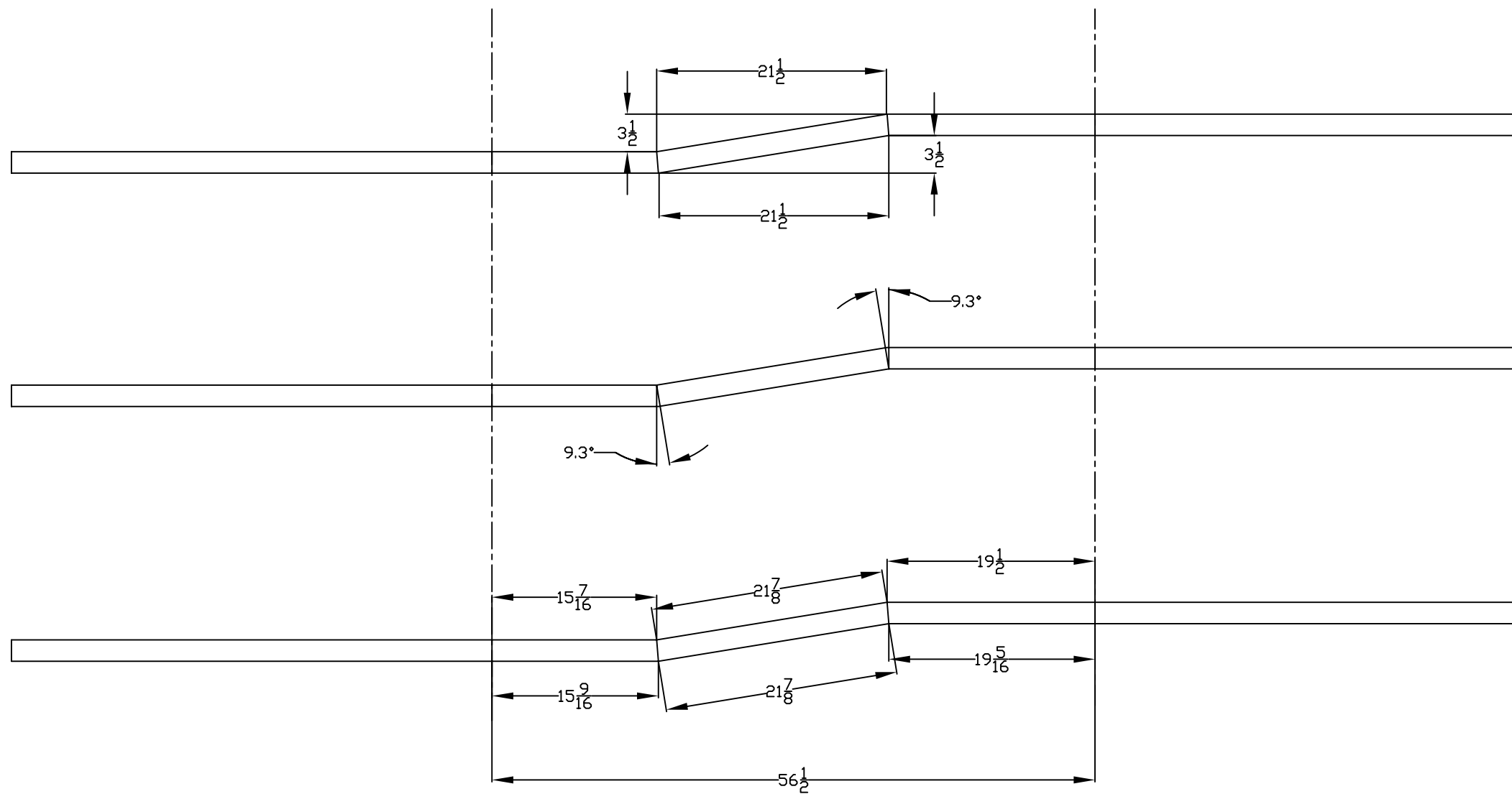
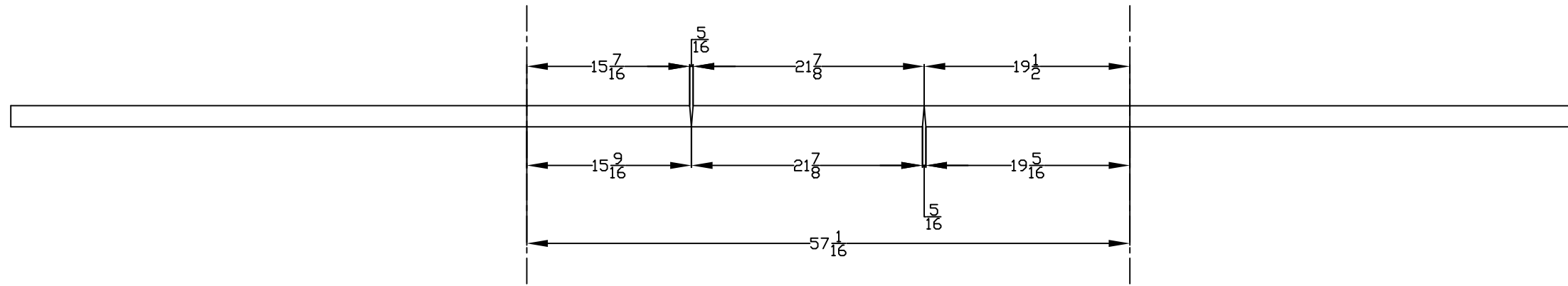

ISS	DATE	MODIFICATIONS	DRAWN	CHKD
				SCALE : NONE
Jeep CJ-7 Passenger Side Rail				
Drawing 3 of 6				
Dwg. no. _____			Project no. _____	

# Layout of Parts

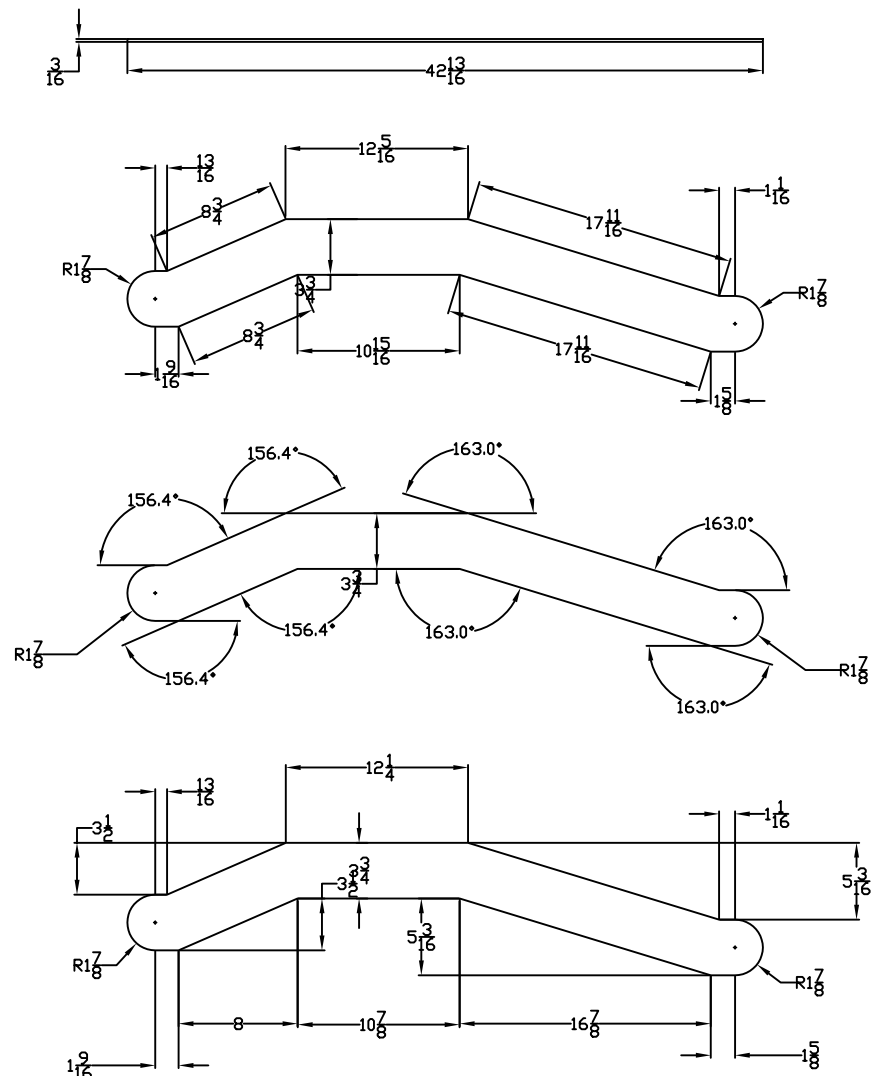
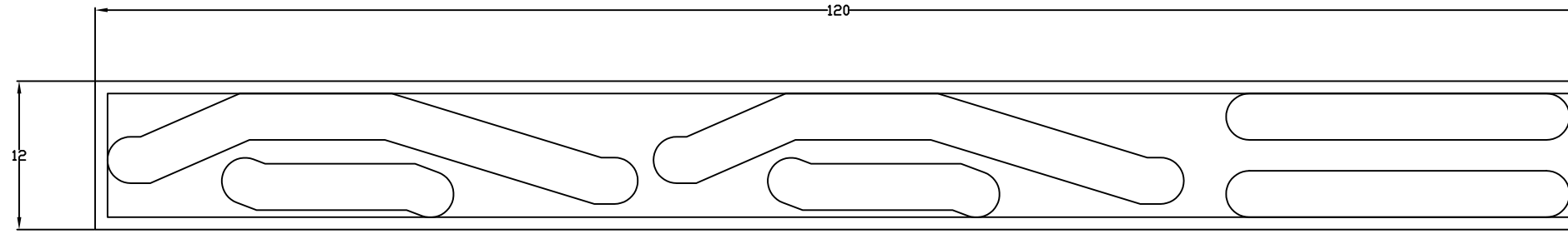

**Section 'A-A'**  
Rear Side Rail Stiffener  
Quantity 4

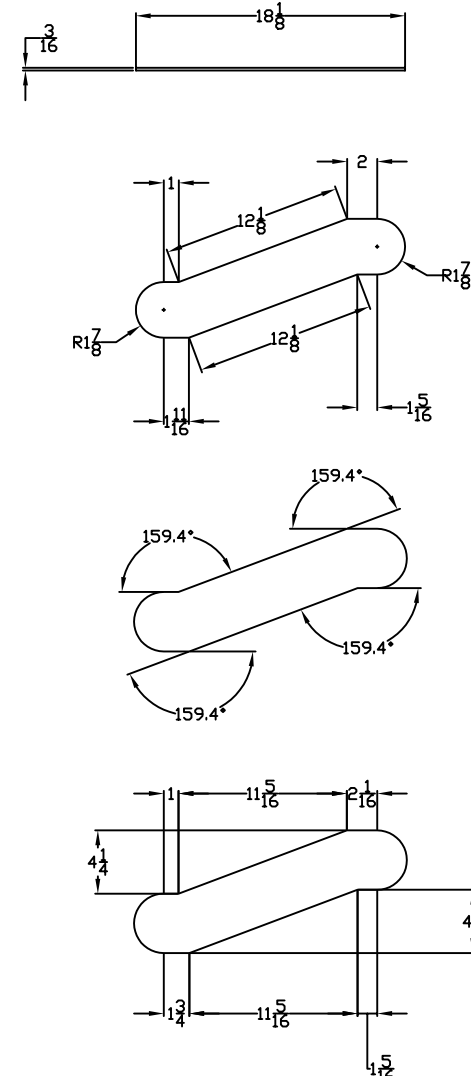

**Section 'B-B'**  
Mid-Rail Stiffener  
Quantity 4

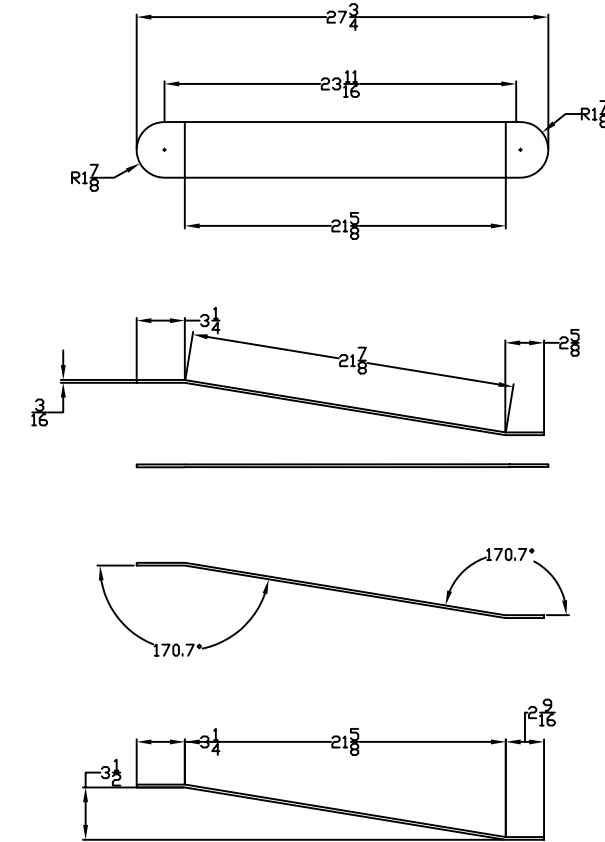

**Section 'C-C'**  
Front Side Rail Stiffener  
Quantity 4

ISS	DATE	MODIFICATIONS	DRAWN	CHK'D
SCALE : NONE				
<b>Jeep CJ-7 Welded Joint Steel Reinforcement Details</b>				
<b>Drawing 5 of 6</b>				
Dwg. no. _____			Project no. _____	

**Chevy 5.0  
Liter  
SB 305  
Engine  
Rebuild**

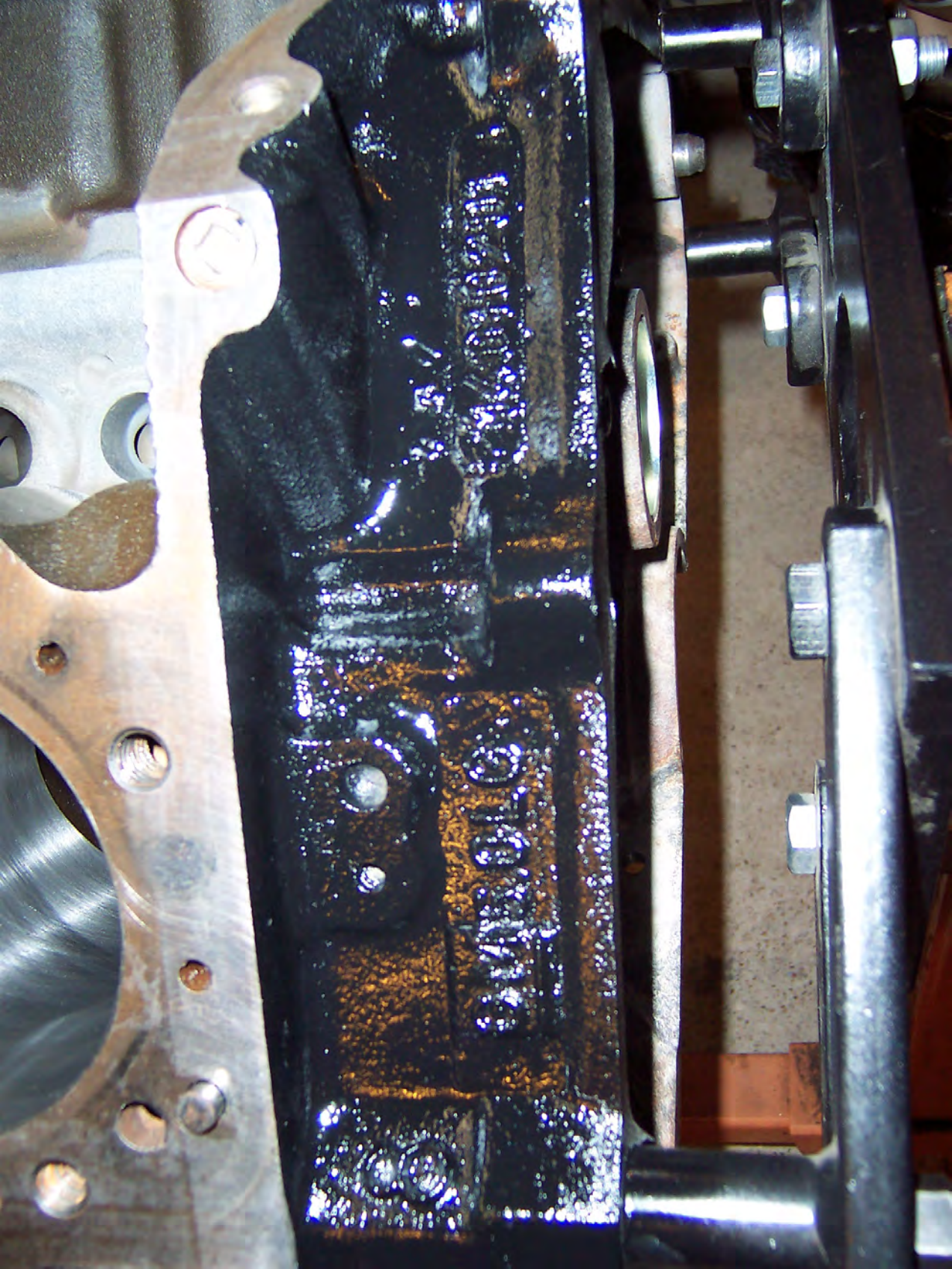



14010200





4544P 020  
151-05-C

4544P 020  
151-05-C

4544P 020  
151-05-C

158015

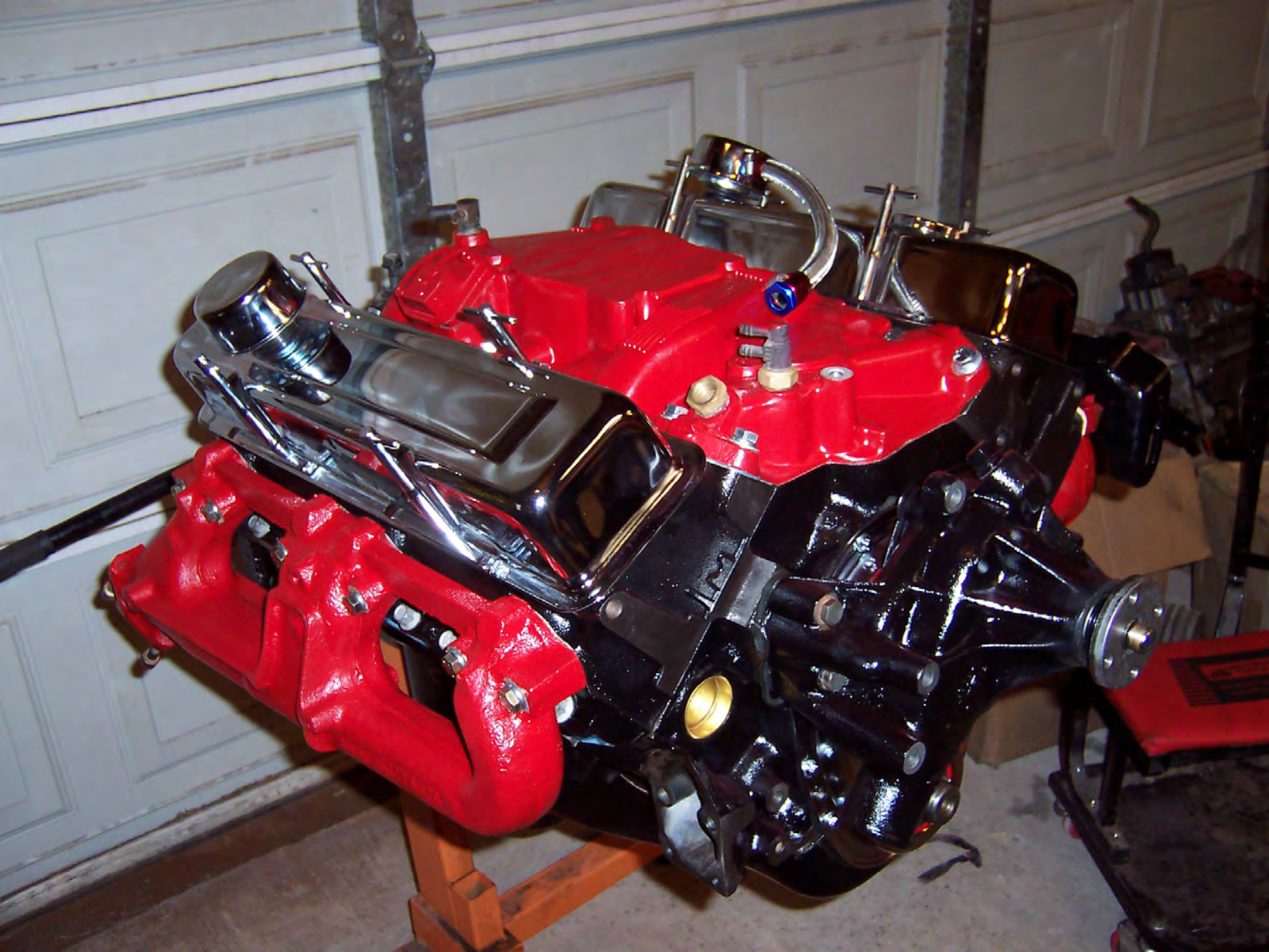



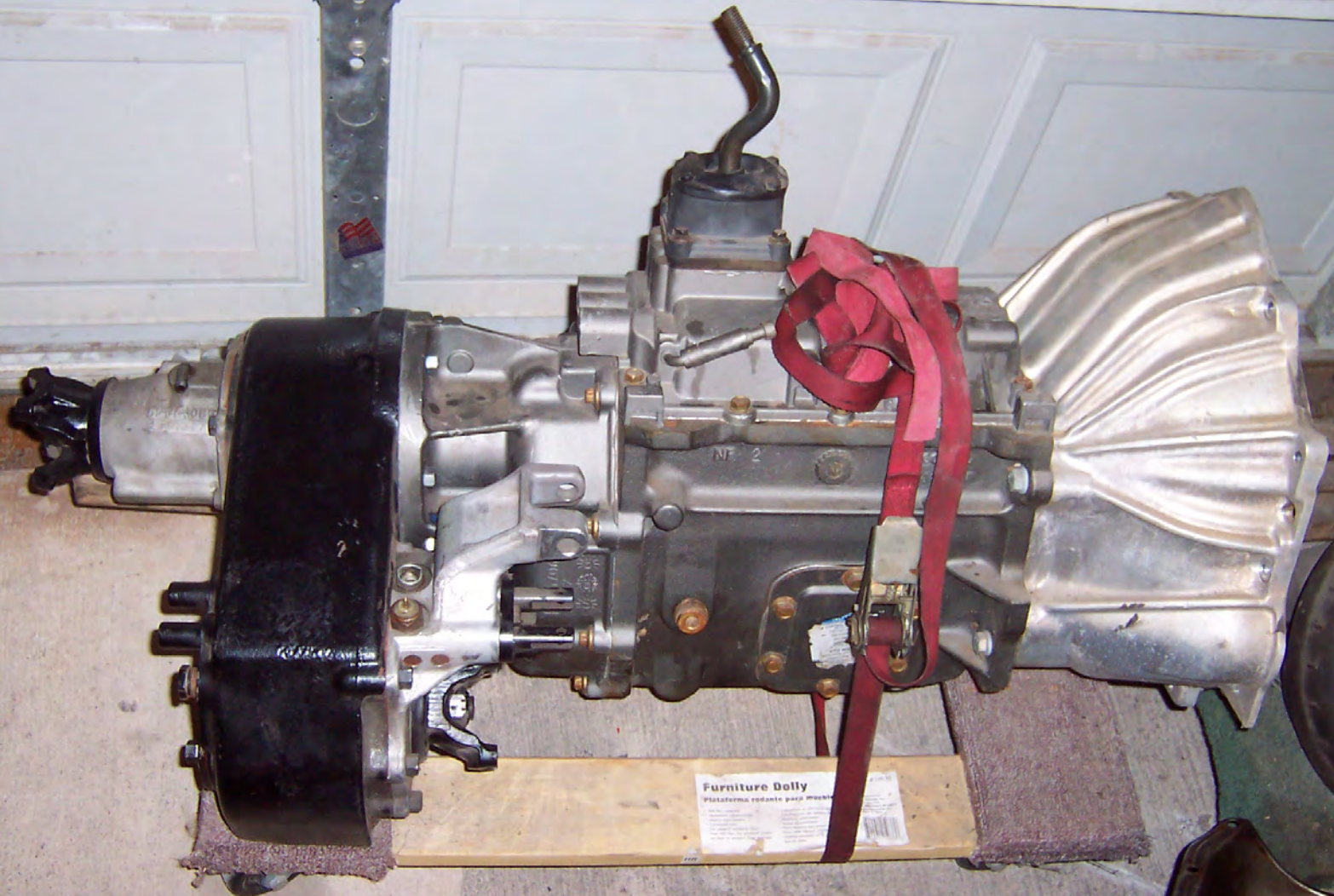

**Furniture Dolly**  
Plataforma rotante para muebles



Really BAD things happen if you forget to put anti-freeze in a freshly built engine!!!

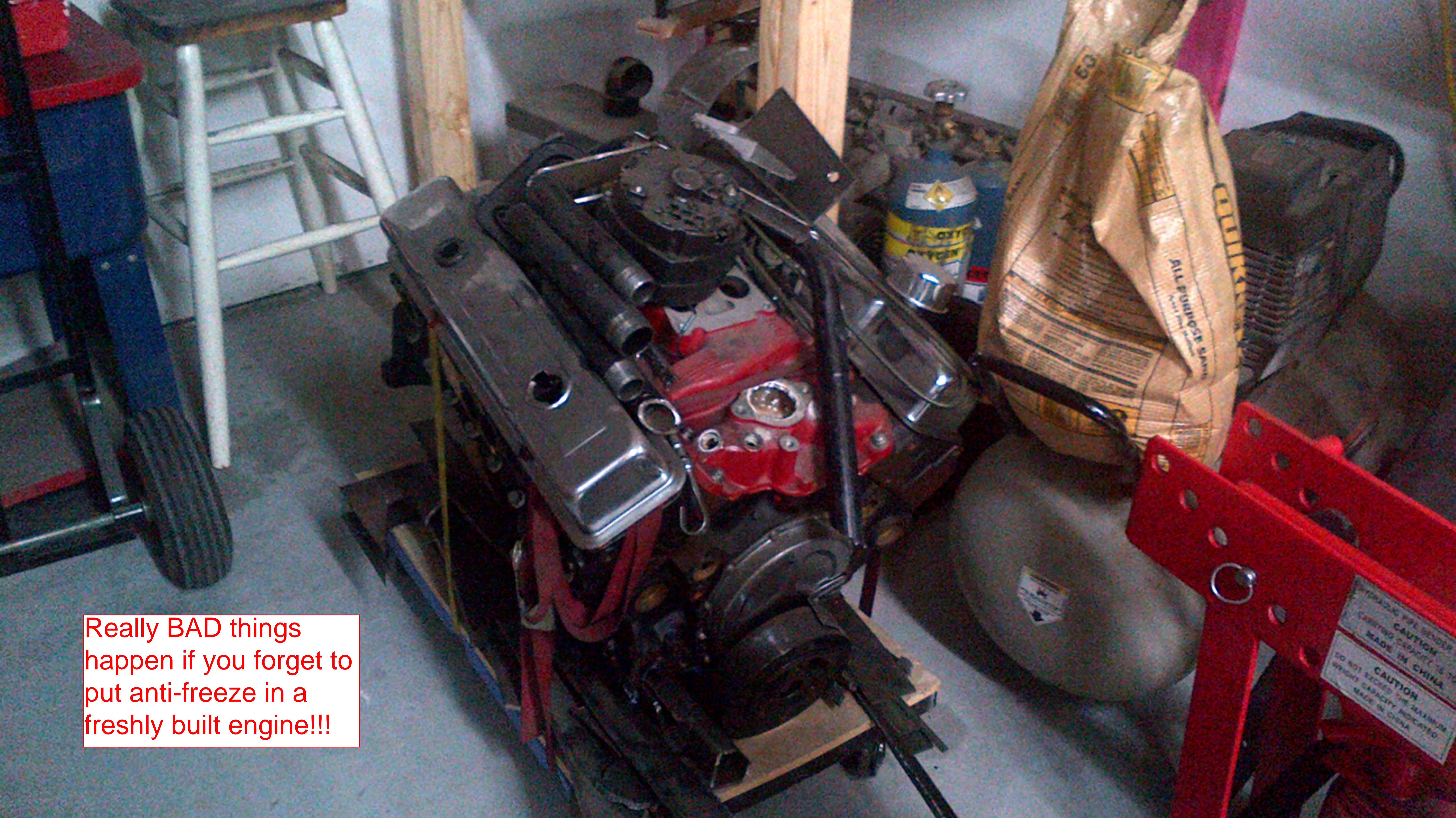

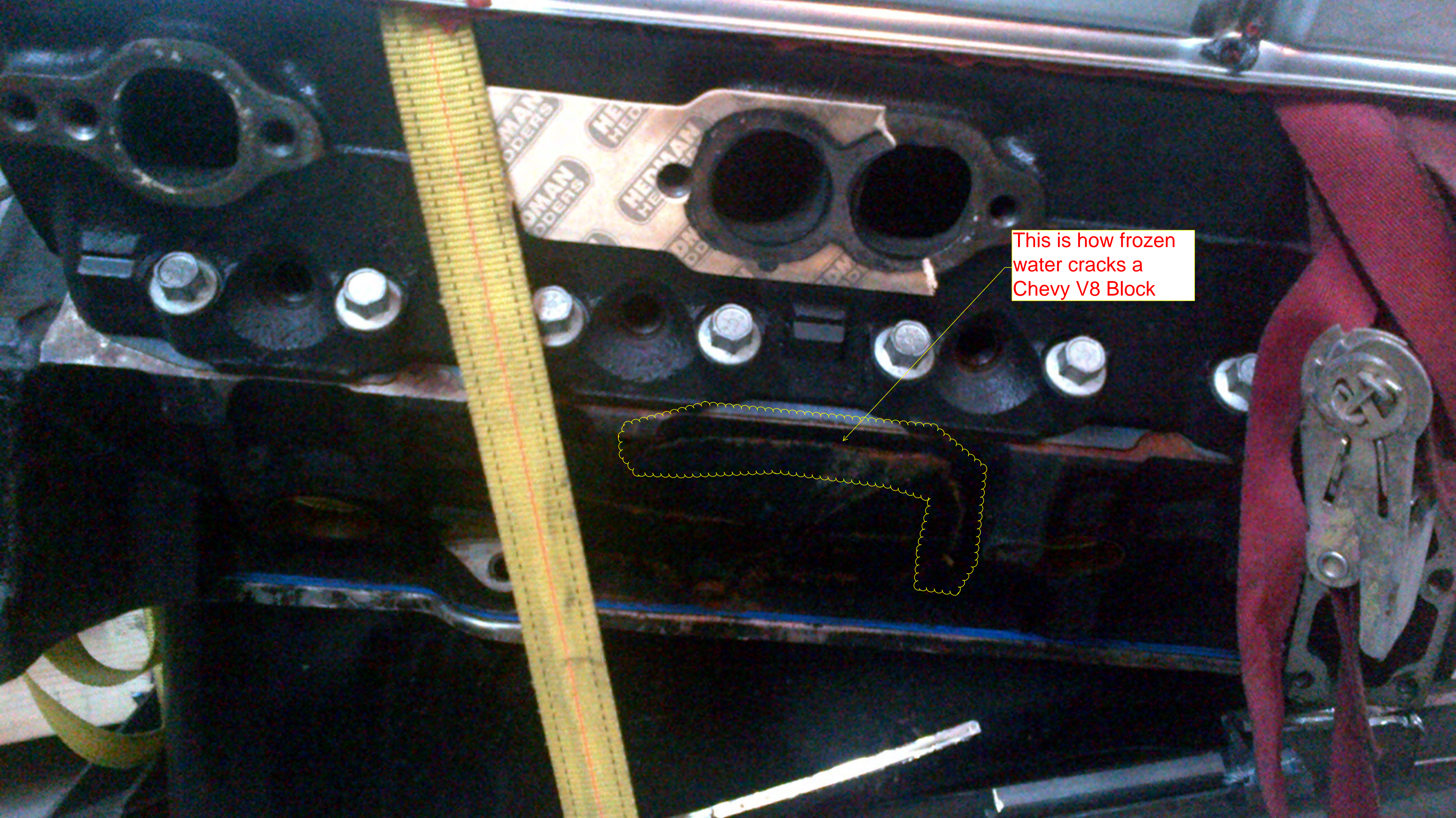

This is how frozen water cracks a Chevy V8 Block

# New Rolling Chassis Buildup





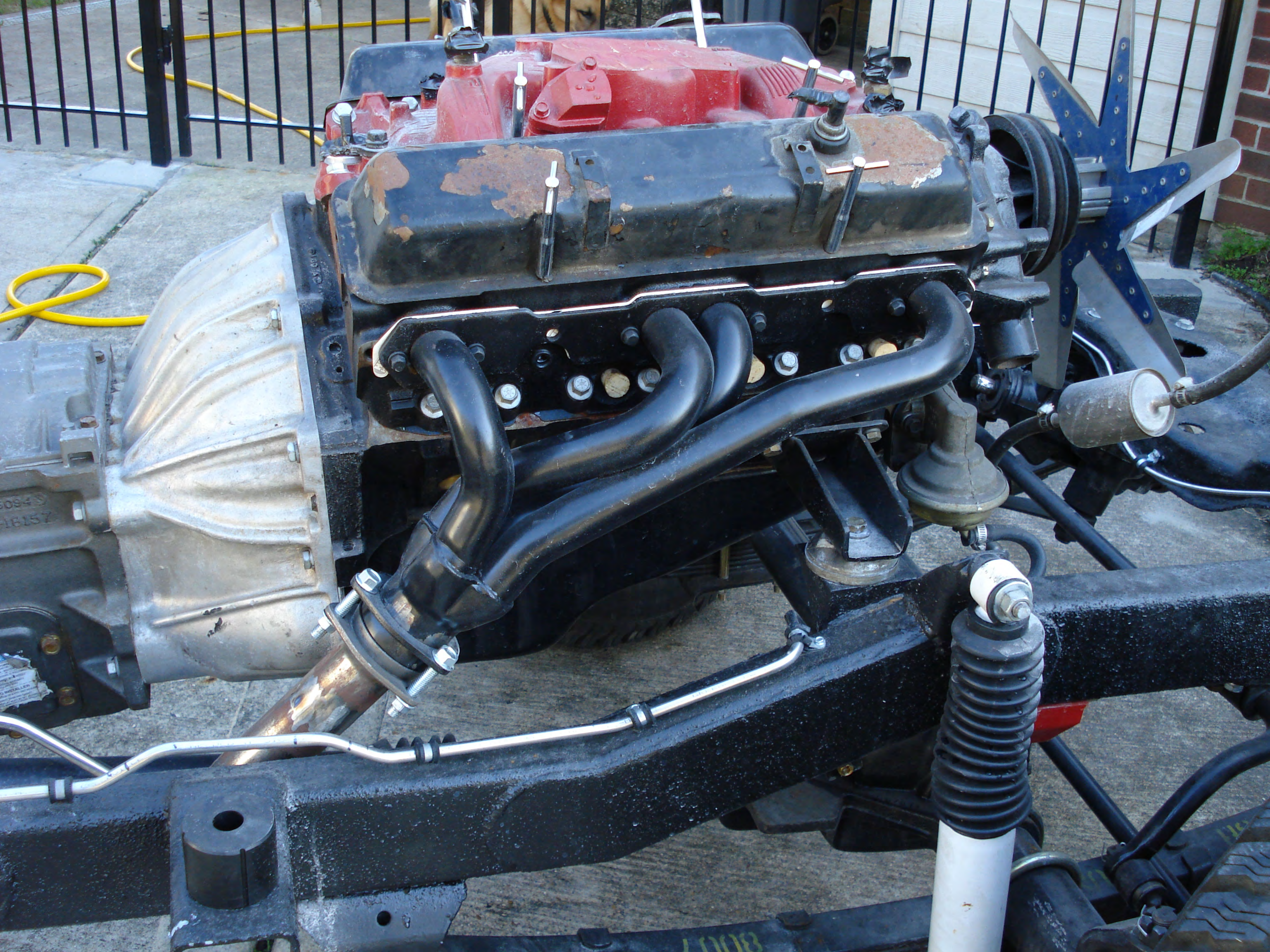

6094 S  
16157

11118



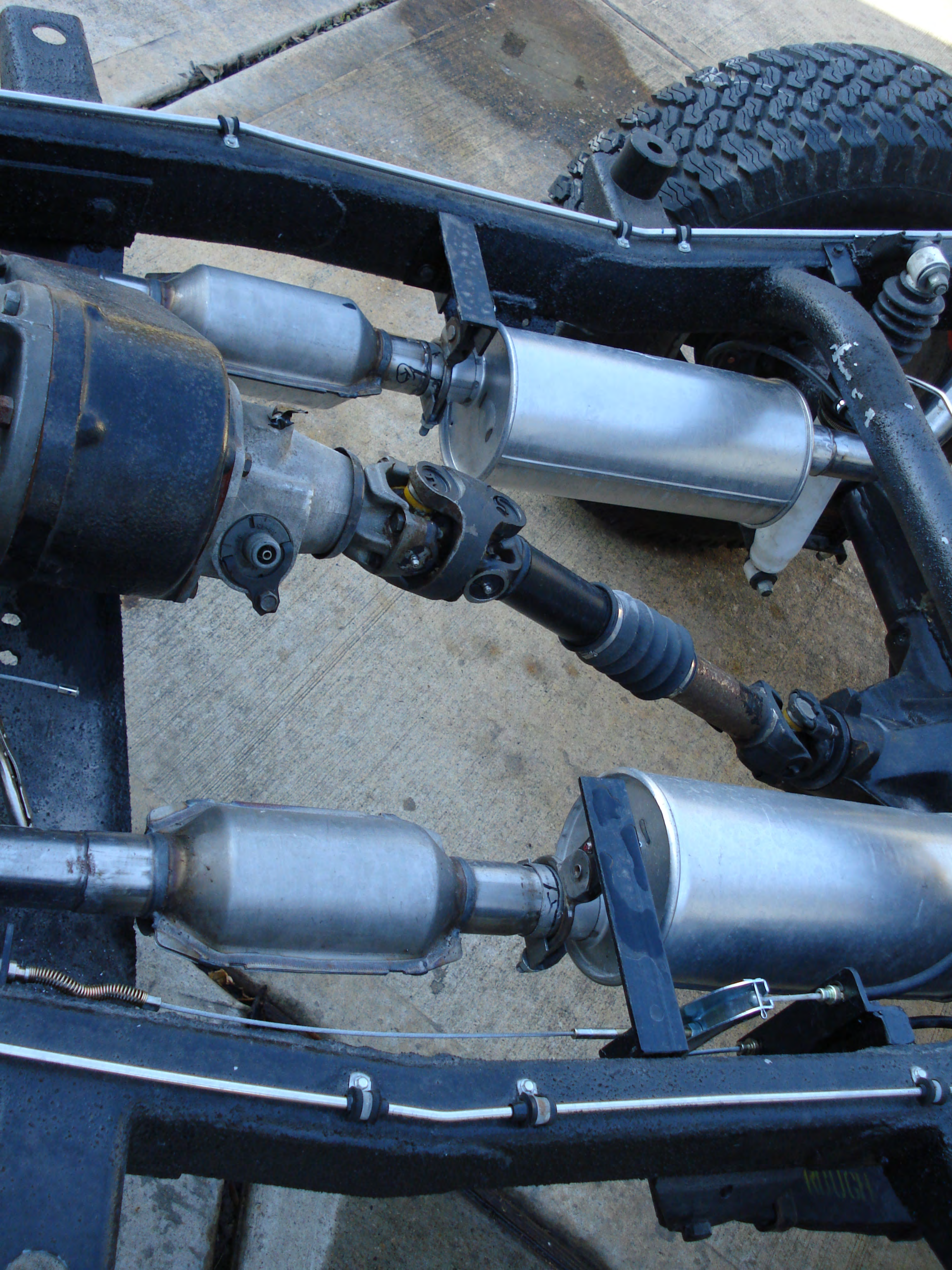





# IT LIVES!!!

1<sup>st</sup> time it was driven on its  
own power.

6/16/10





















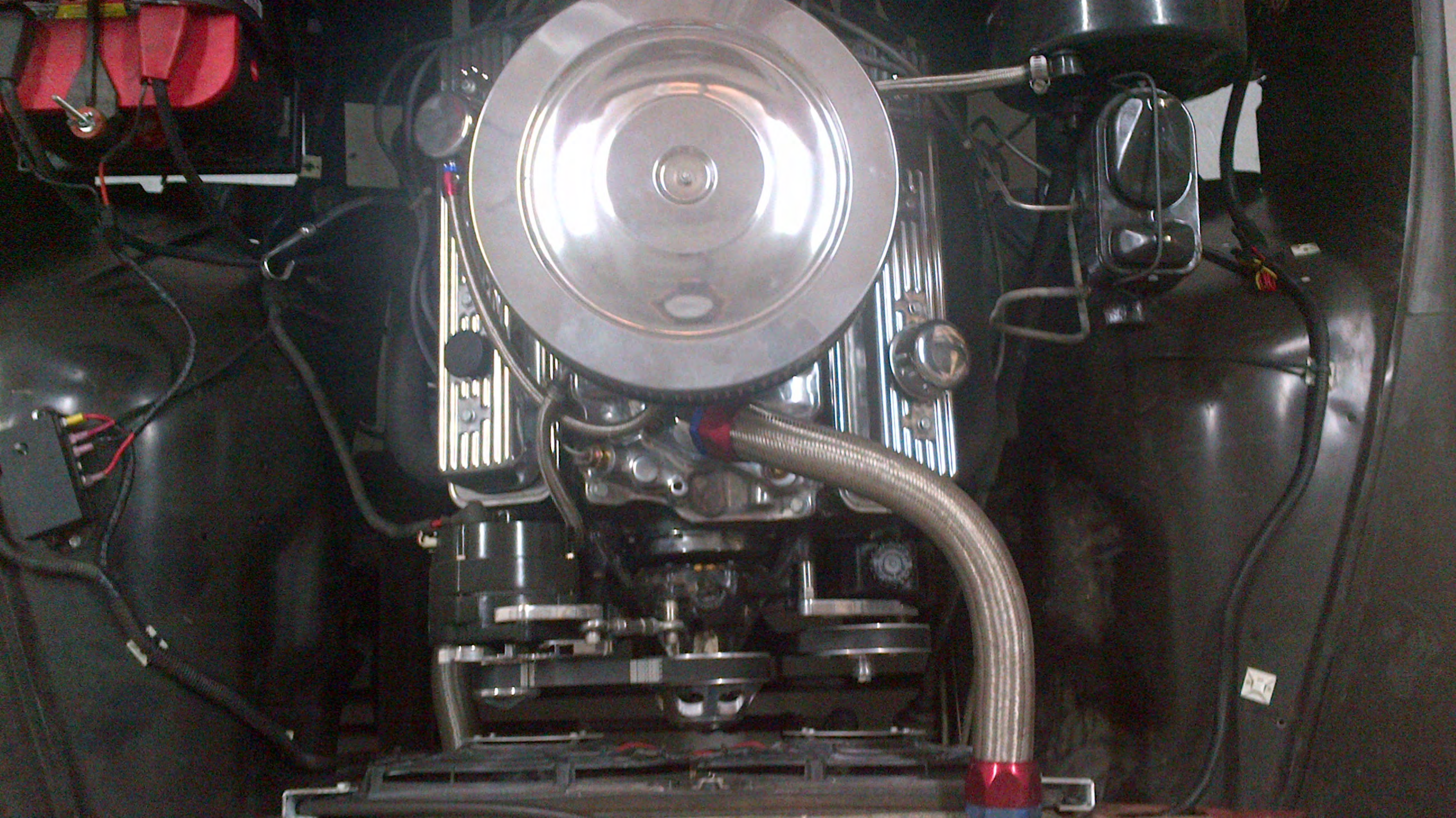







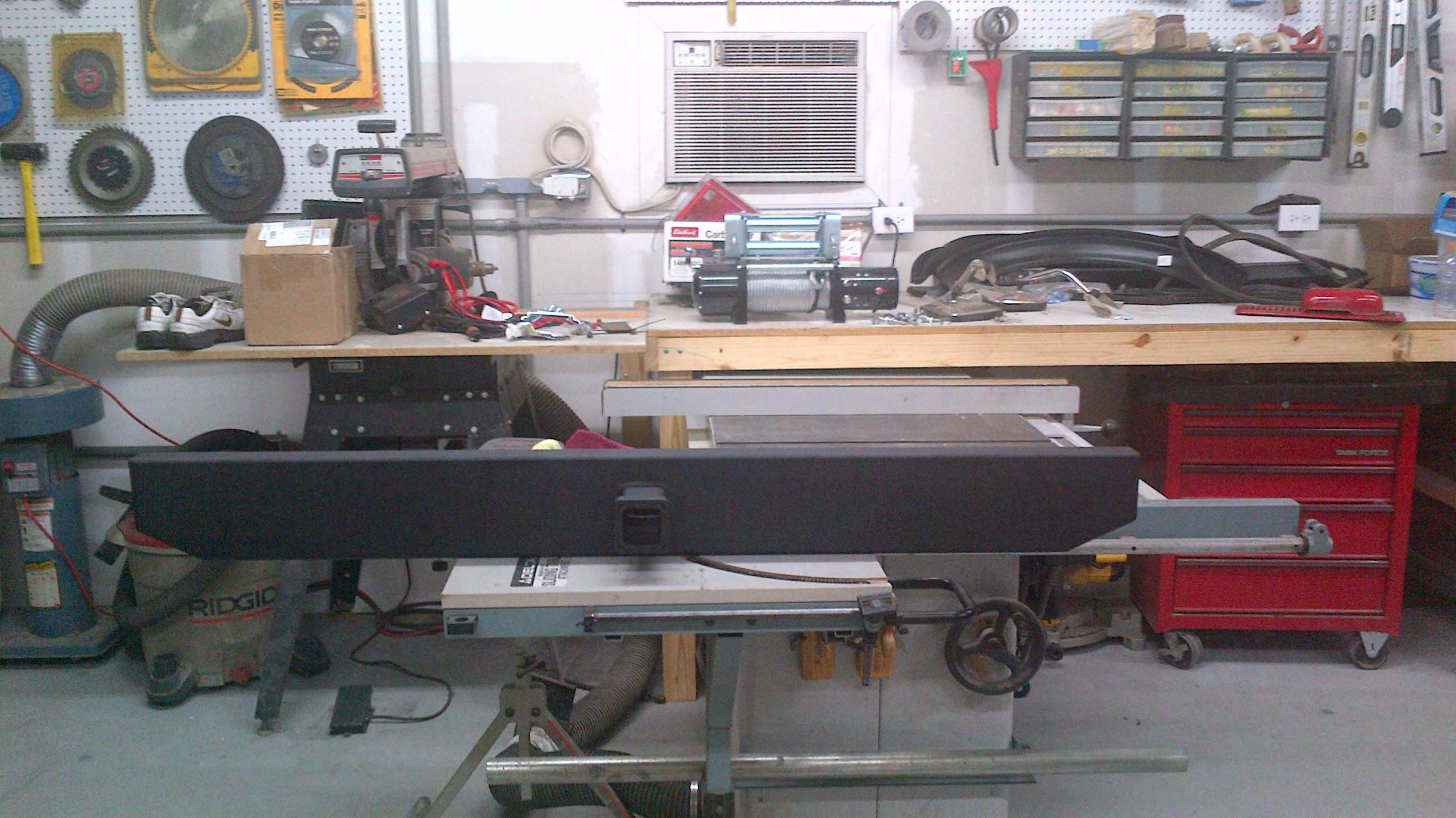







Jeep